

# EXTRA LENGTH DOCK BUMPERS

## EXTRA LENGTH Featuring AD-3 Anchoring Device (up to 3000mm)

### Material/Thickness

- Made of tough rubberised fabric pads, 115mm thick cut from selected recycled truck tyres and belting
- Rubber pads laminated between heavy structural steel angles and secured with 18mm steel tie rods

### Installation

- Structural mounting angles permit welded installations or provide bolting through steel
- No assembly required

### Uses/Applications

- Ideal where refrigeration or warmth is needed
- Have unlimited use in factories, warehouses, docks.
- Projecting above low docks
- Rub rails at the sides of truck wells
- Special construction features to accommodate unusual anchoring conditions
- Wall bumpers to protect against fork lift trucks

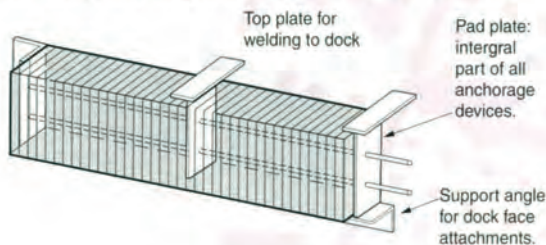

### For refrigeration door or other applications where continuous protection is desired

(A curb angle is suggested for welded anchorage)

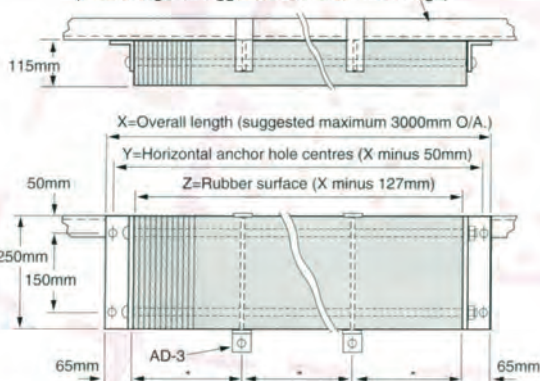

\*Approximate equi-distant, however exact location cannot be determined before fabrication.

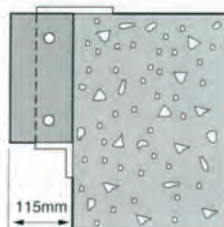

### Ordering Information

Specify model LB410 – 115mm thickness x \_\_\_ mm. Overall Length x Type and Number of Fixing Devices

Specify model LB910 – 230mm thickness x \_\_\_ mm. Overall Length x Type and Number of Fixing Devices

Specify model LB1210 – 350mm thickness x \_\_\_ mm. Overall Length x Type and Number of Fixing Devices (Bumper Length Determines Number of Fixing Devices)

### Example:

Model LB410 x 2575 – AD-3 x 2

i.e. 115mm thick x 250mm depth x 2575mm Overall Length x Anchor Device AD-3 x 2 Devices

### Specifications

- Supply and install Extra-Length Laminated Rubber Dock Bumpers as manufactured by Latham Australia, 14 Tennyson Road, Gladesville, NSW 2111. Ph: (02) 9879 7888 Fax: (02) 9879 7666. Model No.(s) \_\_\_\_\_ Resilient rubber material of bumpers shall be rubberised-fabric truck tyres and belting cut to uniform size pads, 115mm x 250mm and punched to receive 18mm supporting rods.
- All bumpers must be either 115mm, 230mm or 350mm thick (projection from dock), and closed with two structural angles. The angles are welded to 18mm rods at one end and closed with threaded rod and nut at the other end.
- The anchor leg of angle shall extend a minimum of 63mm beyond the rubber surface at either end and contains two 20mm anchor bolt holes as required. (Anchor bolts are supplied separately).
- There are four (4) options for anchorage devices for extra-length bumpers.
- The finish for exposed metal parts shall be painted or galvanised – (specify).

