

EXSLSM Series - Seismic Movement

Flexible Mechanical Expansion Joint Cover

LATHAM AUSTRALIA PTY LTD
 14 TENNYSON ROAD GLADESVILLE 2111 AUSTRALIA
 Phone: 61 2 9879 7888 Fax: 61 2 9879 7666
 Web: www.latham-australia.com



Illustrated: EXSLSM-100 Scale: Approx. 70% full size
 All dimensions are to be verified before construction

Verified By..... Date.....

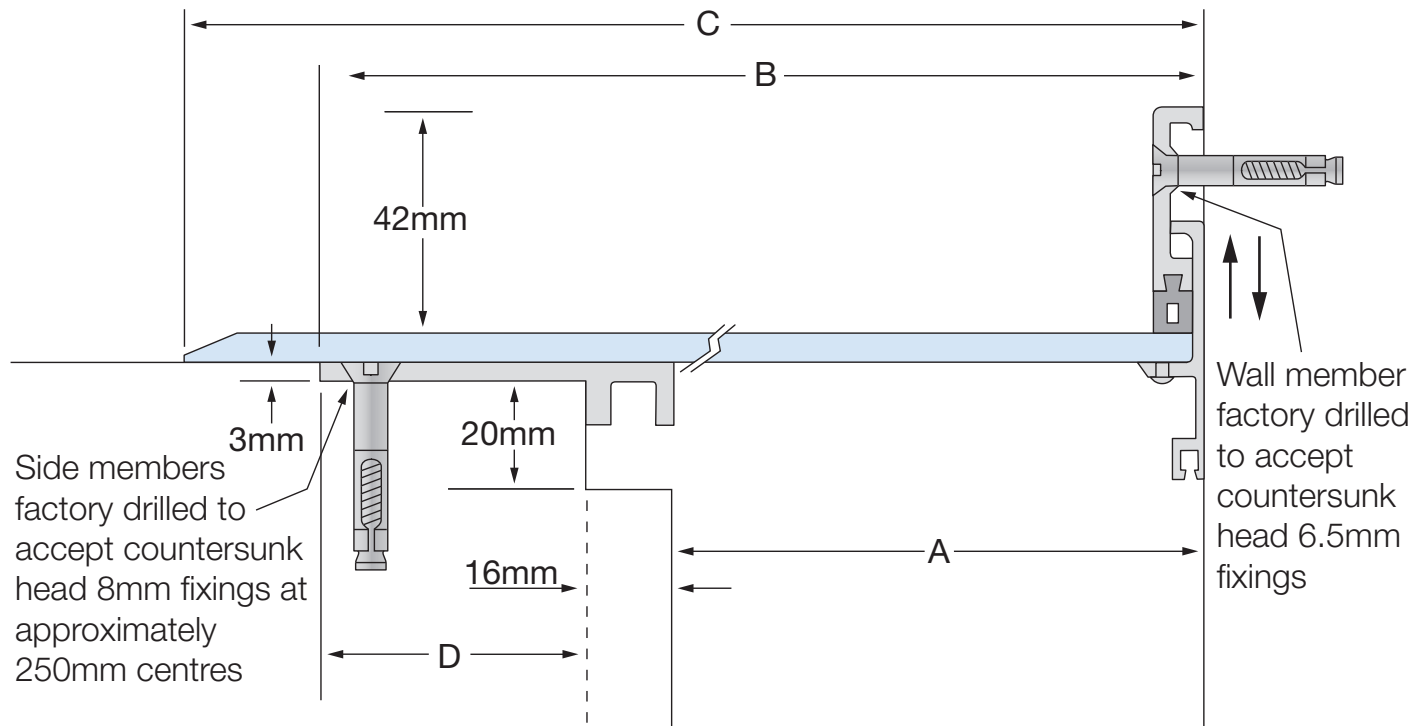

Contact your Latham Representative to discuss the application and specification of this system.

Aluminium Code	A	B	C	D	Movement	Total Available Movement	Overall Depth	Cover Plate Thickness
EXSLSM-100	100	165	225	49	+100/-90mm	190mm	27mm	4mm
EXSLSM-150	150	215	325	49	+150/-140mm	290mm	28mm	5mm
EXSLSM-200	200	265	425	49	+200/-190mm	390mm	29mm	6mm
EXSLSM-250	250	315	525	49	+250/-240mm	490mm	29mm	6mm
EXSLSM-300	300	365	625	49	+300/-290mm	590mm	31mm	8mm

All dimensions are in millimetres.

Exterior/Interior use.

All mechanical expansion joint fixings by others.

The centering bar consists of two elongated spherical rods fastened at opposite ends of a flat spring steel bar. The bar is positioned diagonally across the joint opening with the elongated spherical rods inside the extruded tracks. This unique concept allows for increased rotational movements and maintains constant spring tension at the centre of the cover plate. This greatly reduces the stresses on the embedded anchor sections and the surrounding concrete slabs.

Design subject to change without notice.

COPYRIGHT © 2009

LATH3513